

EXAMPLE SITE PLAN

Scale: 1" = 20'

Parcel Number: 00 - 00 - 00 - 0000 - 0000 - 0000

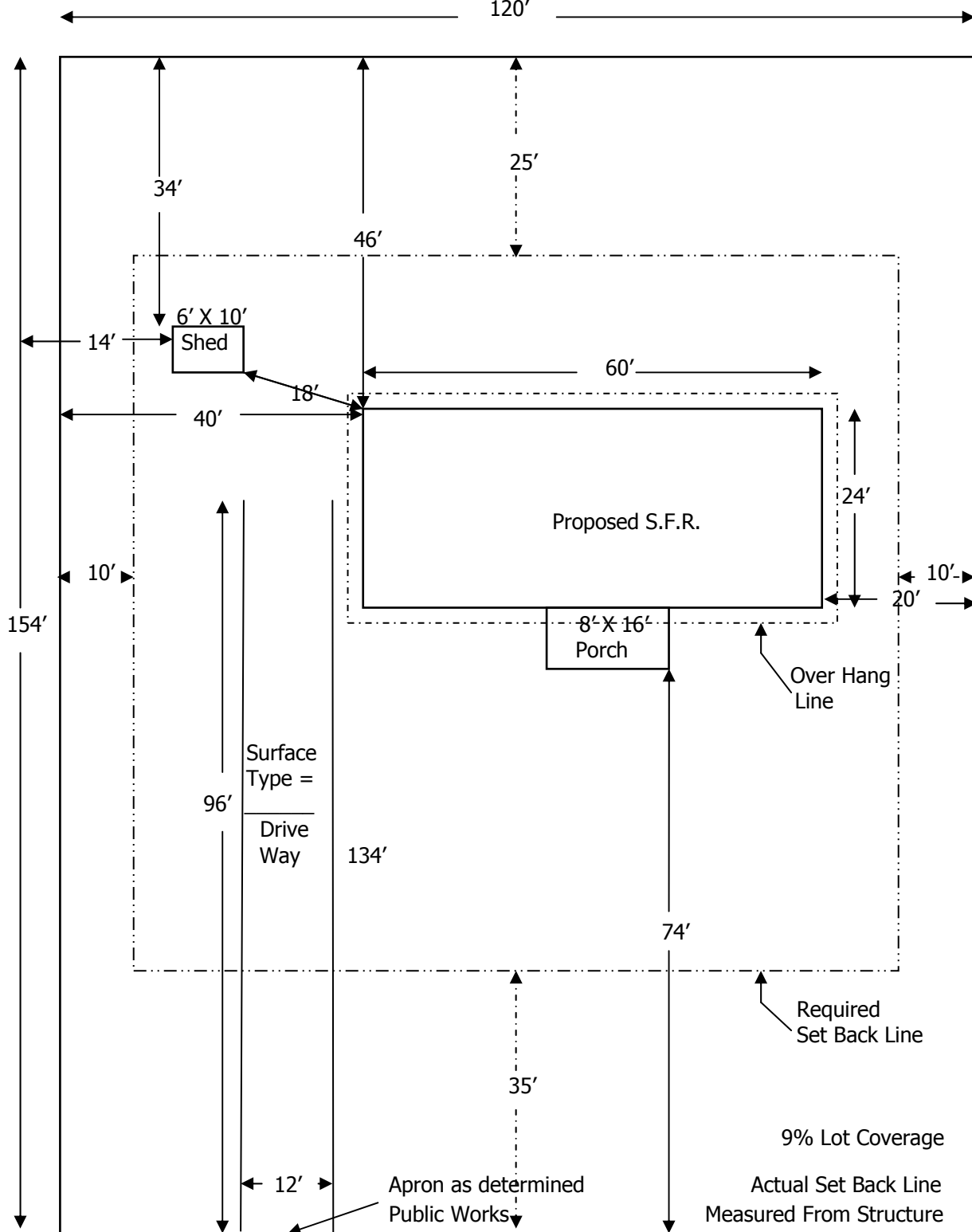

100 First Street

Property Owner: John Doe

Address: 100 First Street

Name of Preparer: Jayne Doe

Zoning: R-2

THIS PLOT IS TRUE AND ACCURATE:

(Signature of Applicant or Agent) John Doe

DATE: 1/1/2006

SITE PLAN CHECKLIST FOR RESIDENTIAL DEVELOPMENT

DOES THE SITE PLAN SHOW	YES	NO	NOTES
The name of the preparer of site plan?			
The property owner as listed on the deed (if different than the preparer of the site plan)?			
The location of the property (9-1-1 address or intersection)?			
The present zoning on the property?			
The dimension of the property (i.e. length of the lot lines)?			
A north arrow? (Must point north relative to property)			
A graphical scale? (Some site plans do not require a scale; if no scale is presented site plan must state "Drawing Not to Scale")			
Date of submittal?			
The signature of the applicant or designated agent?			

STRUCTURES

DOES THE SITE PLAN SHOW	YES	NO	NOTES
The location of all existing and proposed structures and major features?			
The existing structures or major features are labeled "existing" and the proposed structures or major features are labeled "proposed"?			
The dimensions of all structures and major features?			

DOES THE SITE PLAN SHOW	YES	NO	NOTES
The setbacks from property lines for all structures? (Setbacks are measured from the farthest projection of exterior wall.)			
The distance between all structures? (Distance between structures is measured from the farthest projection of exterior wall.)			
The floor area of all structures?			
The percentage of the property covered by structures?			

OTHER FEATURES

DOES THE SITE PLAN SHOW	YES	NO	NOTES
The width, length and surface type of all existing and proposed driveways?			
The existing driveways are labeled: "existing" and proposed driveways are labeled "proposed"?			

FINDING LOT COVERAGE

1 ACRE = 43,560 Square ft.

- 1) First Step: Convert the acreage of the property to square feet by multiplying the acres X 43,560
(Example: .16 acres X 43,560 = **6,969.6** square ft.)
- 2) Second Step: Figure the square ft. of all structures on the property under roof. (This includes the pump houses, sheds, etc.)

(Example: 28' X 56' mobile home	=	1,568 square ft.
10' X 12' shed	=	120 square ft.
4' X 6' shed	=	24 square ft.
<hr/>		
Total	=	1712 square ft.)
- 3) Third Step: Divide the total square ft. of the structures by the square ft. of the acres.
(Example: 1,712 / 6,969.6 = .2456

Move the decimal two places to the right to convert to percentage = **24.5% lot coverage.**)

SITE PLAN

Each Square or _____ Is Equal To _____ Ft. Parcel Number: _____ - _____ - _____ - _____ - _____ - _____

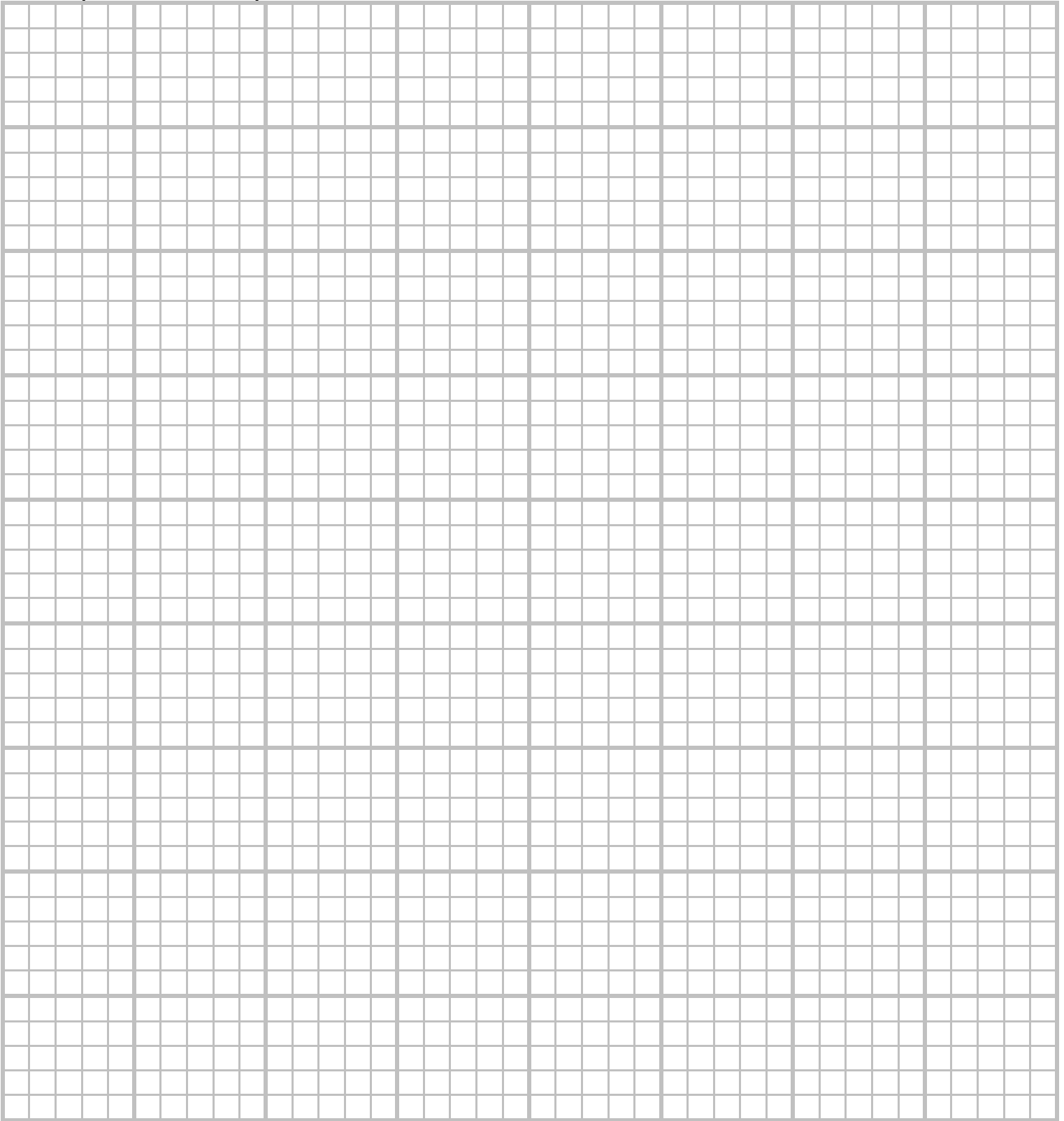

Property Owner: _____

Address: _____

Name of Preparer (if different than above): _____

Zoning: _____

THIS PLOT IS TRUE AND ACCURATE TO THE BEST OF MY KNOWLEDGE:

(Signature of Applicant or Agent) _____ DATE: _____

SITE PLAN

Each Square or _____ Is Equal To _____ Ft. Parcel Number: _____ - _____ - _____ - _____ - _____ - _____

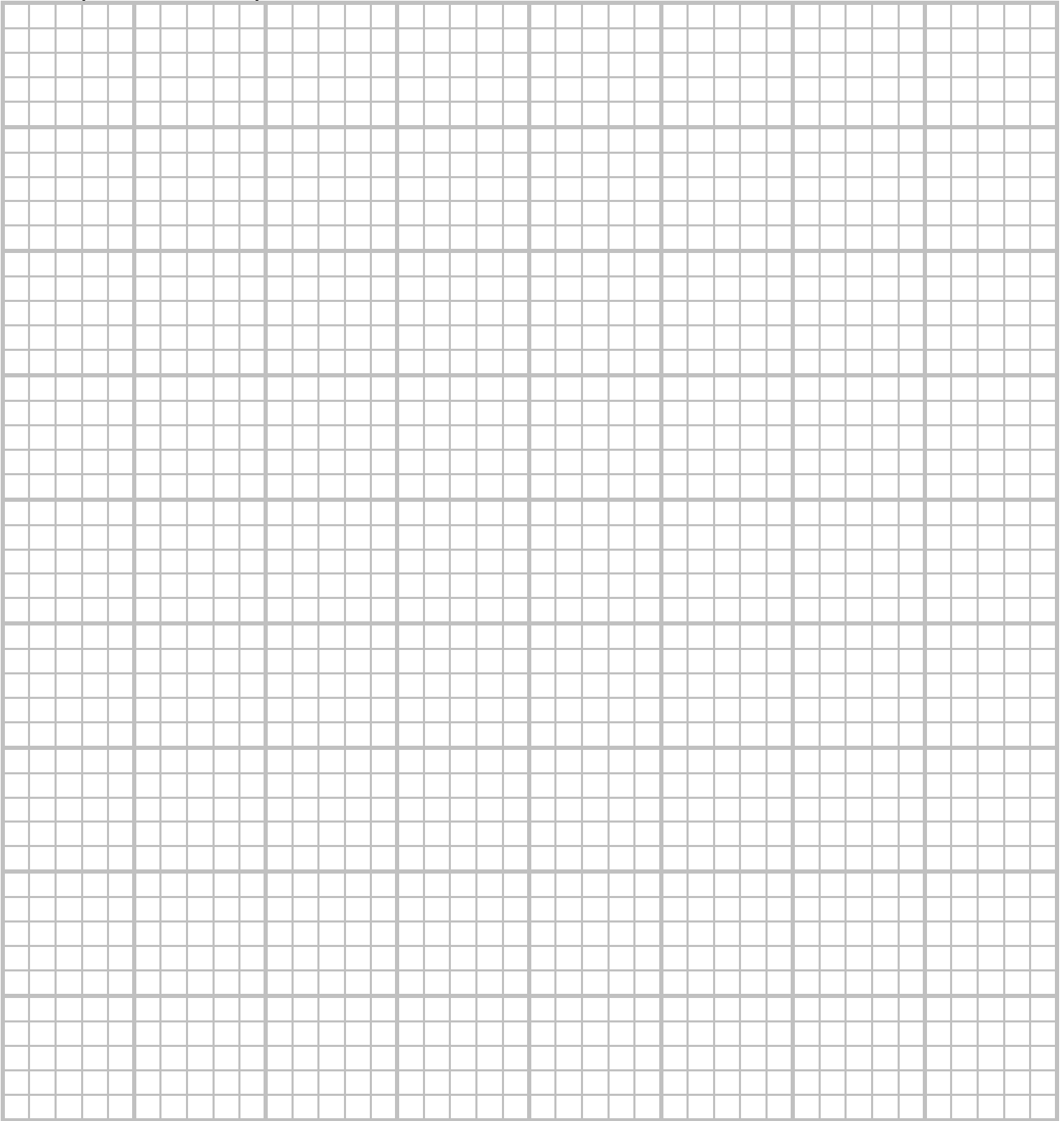

Property Owner: _____

Address: _____

Name of Preparer (if different than above): _____

Zoning: _____

THIS PLOT IS TRUE AND ACCURATE TO THE BEST OF MY KNOWLEDGE:

(Signature of Applicant or Agent) _____ DATE: _____